

## Kugelhahn PN 16/20

Rotguss

## Ball Valve PN 25/32

gunmetal

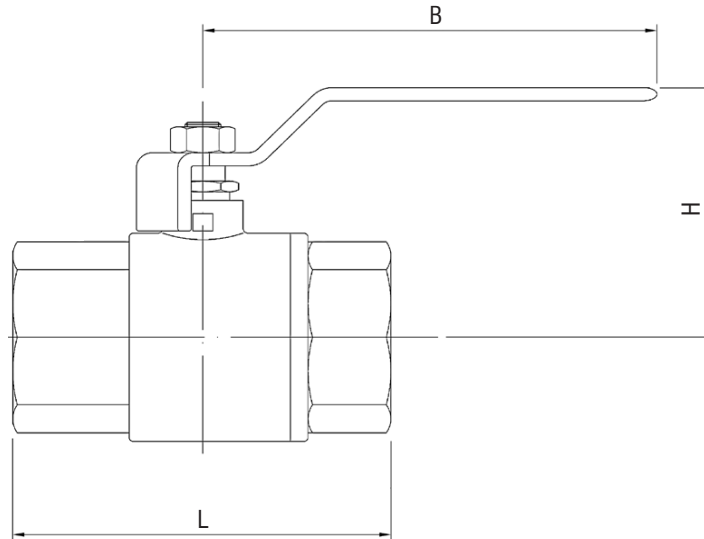

| AW-Nr.<br>AW no. | Pos.<br>item | Bezeichnung<br>denomination | Werkstoff<br>material                                 | nach DIN EN<br>acc. to DIN EN | Werkstoff-Nr.<br>material no. |
|------------------|--------------|-----------------------------|---|-------------------------------|-------------------------------|
| <b>4013</b>      | 1            | Gehäuse / body              | Rotguss / gunmetal                                    | CuSn5Zn5Pb5-C                 | CC491K                        |
|                  | 2            | Spindel / stem              | Messing / brass                                       | CuZn39Pb3                     | CW614N                        |
|                  | 3            | Schalthebel / lever         | Stahl, kunststoffummantelt /<br>steel, plastic coated |                               |                               |
|                  | 4            | Dichtung / sealing          | PTFE / Teflon   |                               |                               |

| G      | PN | DN   | L     | H     | B     | ≈ kg  |
|--------|----|------|-------|-------|-------|-------|
| 1/4"   | 20 | 10   | 45    | 31,5  | 89    | 0,180 |
| 3/8"   | 20 | 10   | 45    | 31,5  | 89    | 0,180 |
| 1/2"   | 20 | 14,5 | 51,5  | 50,5  | 89    | 0,210 |
| 3/4"   | 20 | 19   | 56,5  | 53    | 104   | 0,320 |
| 1"     | 20 | 24,5 | 67,5  | 68    | 117,5 | 0,550 |
| 1 1/4" | 20 | 32   | 81,5  | 77    | 117,5 | 0,780 |
| 1 1/2" | 16 | 40   | 92    | 83,5  | 145   | 1,280 |
| 2"     | 16 | 50   | 106,5 | 92    | 145   | 1,750 |
| 2 1/2" | 16 | 64   | 136   | 114   | 232   | 3,550 |
| 3"     | 16 | 79   | 160,5 | 123   | 232   | 5,580 |
| 4"     | 16 | 99   | 185   | 139,5 | 232   | 8,450 |

Temperatur / temperature

0°C bis / up to +150°C  
 nach / acc. to PN